

Application

- two-way shut-off valve

Working medium

- abrasive and dense hydraulic mixtures
- liquid suitable for used rubber
- water and wastewater with working temperature up to 50°C

Maximum working overpressure

- max. 0,7 MPa (DN 100)
- max. 0,8 MPa (DN 80)
- max. 0,9 MPa (DN 65)
- max. 1,0 MPa (DN 25, DN 40, DN 50)

Technical description

- mechanical hose throttle valve
- rotating rising stem with thread inside the valve chamber
- easily replaceable rubber liner
- rising hand wheel
- cast iron components inside protected by epoxy coating

Operating

- hand wheel
- seat closes, once the hand wheel is twisted to the right

Testing

- by water acc. to EN 12266-1
- leakage rate A

Connection to piping

- flanged (type 21, form B) acc. to EN 1092-2
- face to face dimension part 1 ČSN 13 3045 for PN 10
- sealing strips are a part of the liner

Installation and maintenance

- The valve is installed in horizontal or vertical.
- If the valve is used as an end seat, the end element of whole assembly must be the counter flange.

Material

Component	Material
body	cast iron EN-JL 1040 (GG-25)
bonnet	stainless steel 1.4021 (13% Cr)
liner	rubber M3204 (type 001); EPDM (type 002)
bolts	steel, zinc
washer	
nut	

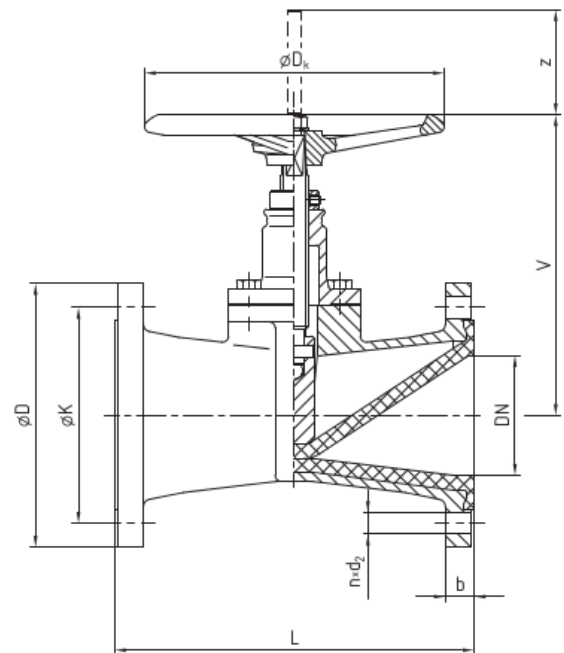

DN 25-100
PN 10

PN 10

DN	L	Dk	V	z	b	D	d2	K	n	bolt	kg	max. closing torque
25	160	125	125	23	17	115	14	85	4	M12	4,5	15
40	170	160	140	30	18	150	19	110	4	M16	7	20
50	180	160	160	37	20	165	19	125	4	M16	9	25
65	200	200	190	50	20	185	19	145	4	M16	11	30
80	210	200	205	60	22	200	19	160	8	M16	16	40
100	230	250	245	70	22	220	19	180	8	M16	22	50

The ARMATURY Group a.s. company reserves the right for changes of technical products-specifications, and is not responsible for incidental misprints. Issued in February 2016.